

Model S08

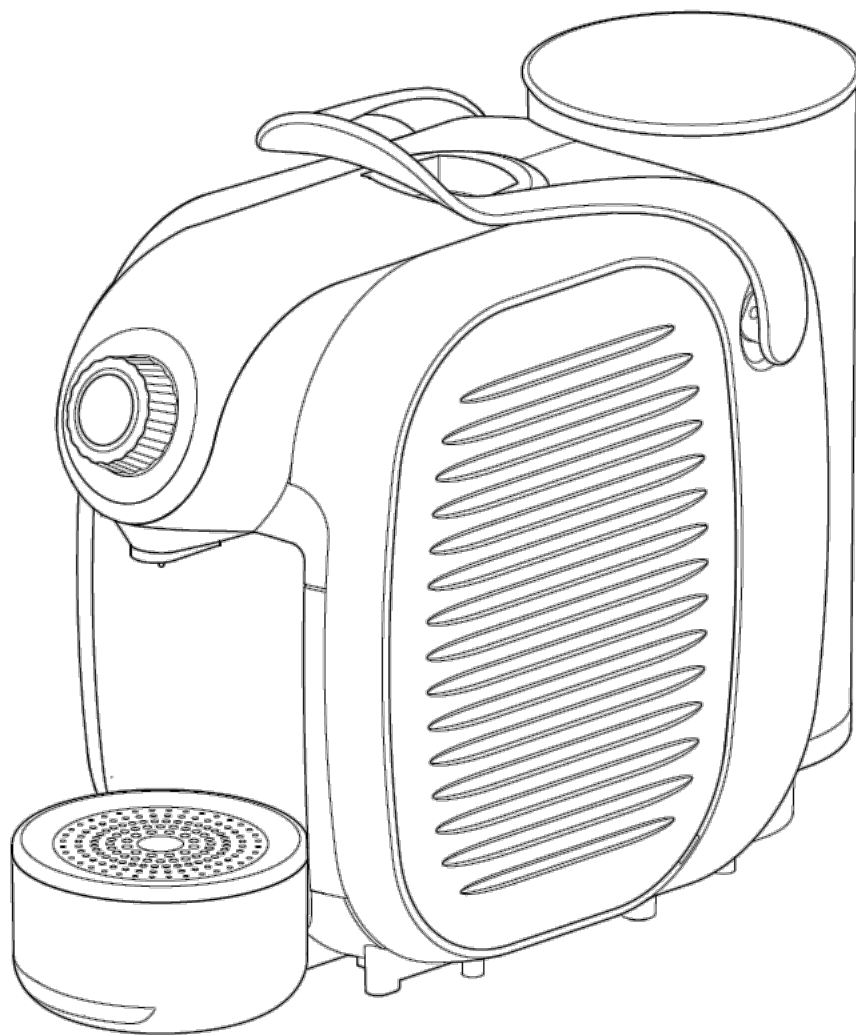

**Imported by Roasting Australia Pty
Limited**

11 Hoyle Avenue, Castle Hill NSW

2154 Ph: AU: 02 9846 0307

NZ: 0800 450 894

Email: caffitalysystem@rfg.com.au

caffitalysystem.com.au



SAFETY WARNINGS

CAREFULLY read the following instructions!

In this way you will avoid the risk of personal injury and damage to the appliance.



This appliance is intended to be used in domestic environments. Not suitable for Professional use.



ONLY use Caffitaly System compatible capsules. Damage caused by using incorrect capsules will void the Warranty.



Use the TEA button (Blue) for Tea and Hot Water ONLY! Incorrect use of this button will cause damage to the machine and void the Warranty.



Use of the appliance in any manner other than as directed within this manual could cause harm to the operator and void the Warranty. The manufacturer will not be responsible for injury or damage resulting from improper use of the appliance.



After removing the packaging, check that the appliance is not damaged. If damage is detected, or upon the first sign of a defect (unusual noise or odours), or if any other problem is detected inside the appliance, do not use it and contact the **Caffitaly System Customer Service Line on AU 02 9846 0307 | NZ 0800 450 894.**



The packaging elements (plastic bags, etc.) must not be left within reach of children as they are potential sources of danger.



Only use the appliance if the power cord is intact. If the cord is damaged it must be replaced by the manufacturer or importer due to potential electrical safety risks. **Contact the Caffitaly System Customer Service Line on AU 02 9846 0307 | NZ 0800 450 894.**



Use and store the appliance indoors. Make sure the electrical elements, plug and cord are dry. Never submerge the appliance in water. Protect the appliance from sprays and drips. Water and electricity together constitute a risk of electrocution.



Do not leave the power cord near hot surfaces, sharp edges or other sharp objects.



Only connect the appliance to power outlets complying with the requirements of the law. Make sure that the power supply voltage matches the rating shown on the data plate on the bottom of the appliance. This appliance includes an earthed pin and must be used with a power outlet with earthed connection.



Do not pull on the power cord to disconnect it. Remove the plug carefully to avoid damage to the outlet.

SAFETY WARNINGS - Continued



This appliance is not intended for use by persons (including children) with reduced physical, sensory or mental capabilities, or lack of experience and knowledge, unless they have been given supervision or instruction concerning use of the appliance by a person responsible for their safety. **Children should be supervised to ensure that they do not play with the appliance**



Never place your hands inside the capsule compartment. There is a risk of injury.



Do not open the lever while the appliance is operating. If the lever is raised during the delivery of a product, the machine can emit jets of hot water. Risk of Burns!



Do not remove parts of the appliance, OR insert objects into the openings. This could cause electric shocks! Any operation that is not described in this instruction manual should only be performed by an Authorised Support Centre. Please contact the **Caffitaly System Customer Service Line on AU 02 9846 0307 | NZ 0800 450 894.**



Install the appliance on a solid, stable, heat resistant surface with an incline no greater than 2 degrees.



When the **Indicator Light** blinks ORANGE and the machine beeps, it is advisable to perform the descaling cycle, as illustrated on **Page 15**. If you do not, the appliance may be damaged.



Clean the appliance carefully and regularly with a soft cloth and a mild detergent, do not use alkaline cleaning agents. If it is not cleaned, the build-up that forms may be hazardous to your health. Unplug the appliance and allow it to cool before cleaning.



Unplug the machine if you do not expect to use the appliance for a long period of time (leaving on vacation, etc.)

SYMBOLS GUIDE



CAUTION: This is the safety warning symbol. It is used to call your attention to possible risks of personal injury. Abide by the safety messages provided in order to avoid possible injury or death.



This is the symbol used to highlight some actions that will optimise the use of this appliance.



Not
Dishwasher
Safe



Maintenance
Tips

INTRODUCTION

Safety Warnings	1
Symbol Guide	2
Contents	3
Caffitaly System Customer Care Line	3

INSTALLATION AND USE

Machine Components	4
Instruction Images	5
First Use or after a long period of disuse	7
Correct Use of the Dial	7
Turning on the Appliance	8
Dispensing Coffee using Factory Settings	8
Adjusting the Cup / Mug Height	9
Programming the Quantity of Coffee in a Cup	9
General Operating Indications	9

CLEANING AND MAINTENANCE

Daily Maintenance	10
Descaling	10
Troubleshooting	10
Energy Saving	12
Instructions for Use and Disposal	12
Troubleshooting	12
Technical Data	13

Thank you for having chosen our product and for your confidence in our company.

You can savour your favourite hot beverages at any time of the day with our appliance by choosing one of the capsules that Caffitaly System offers you.

For example: an espresso, a cocoa flavoured beverage or a tea will be ready in just a few seconds.

CAFFITALY SYSTEM CUSTOMER CARE INFORMATION

Ph: AU: 02 9846 0307

NZ: 0800 450 894

Email: caffitalysystem@rfg.com.au

MACHINE COMPONENTS - DIAL

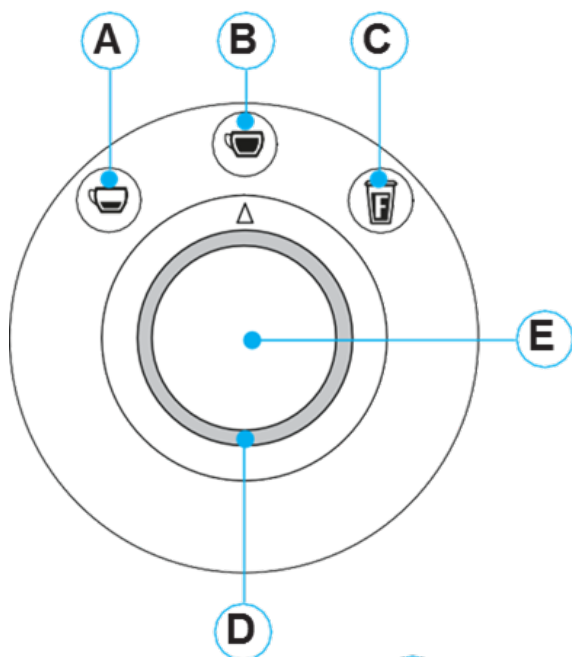

- A: Single Espresso Indicator Light
- B: Double Espresso Indicator Light
- C: Tea or Hot Water Indicator Light
- D: Multifunction Indicator Light
- E: Dispensing Button

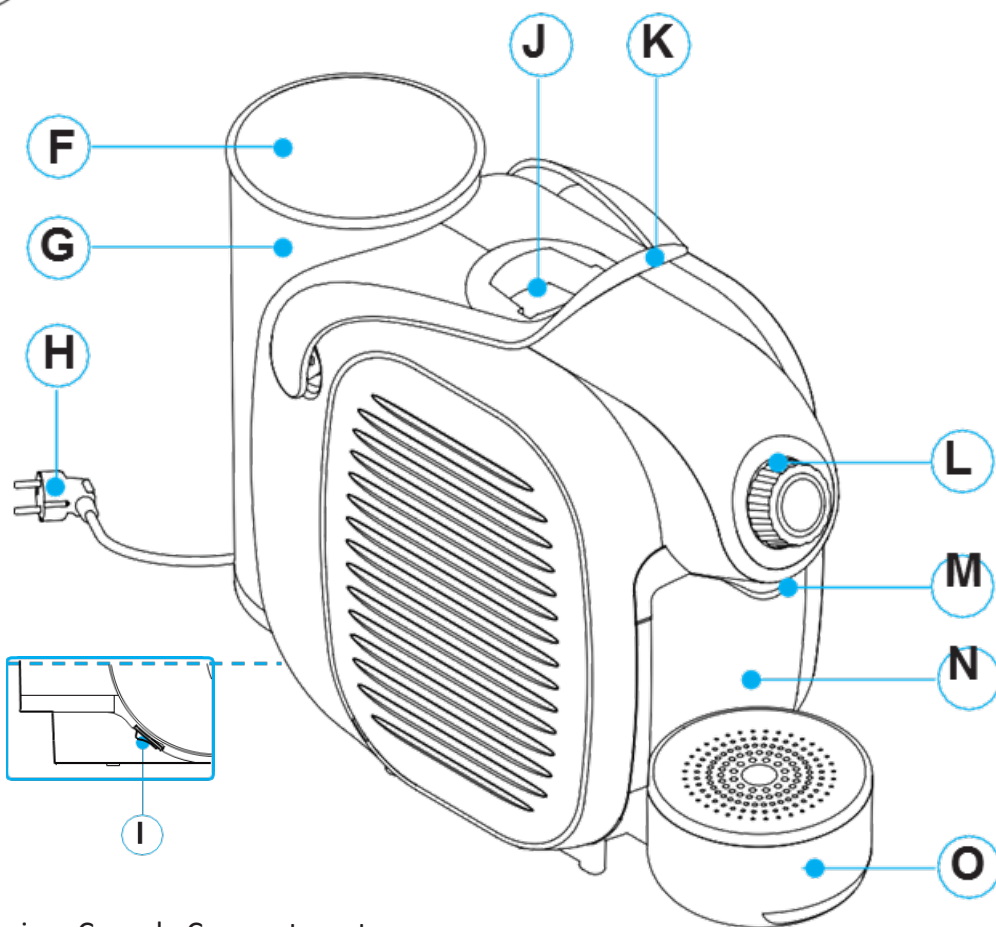

- F: Water Tank Cover
- G: Water Tank
- H: Power Cord
- I: Power ON/OFF Switch
- J: Capsule Compartment
- K: Lever for Opening / Closing Capsule Compartment
- L: Dial
- M: Dispensing Spout
- N: Used Capsule Drawer
- O: Drip Tray

INSTRUCTION DIAGRAMS

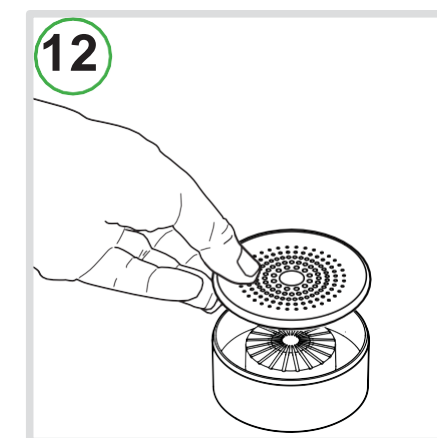
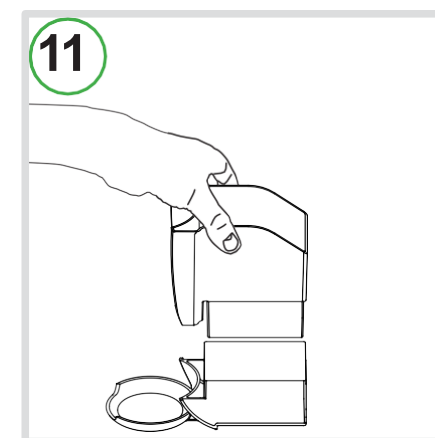
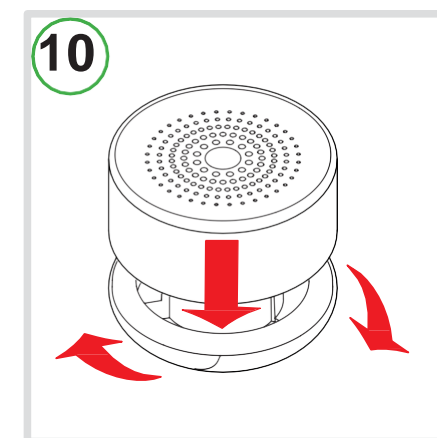
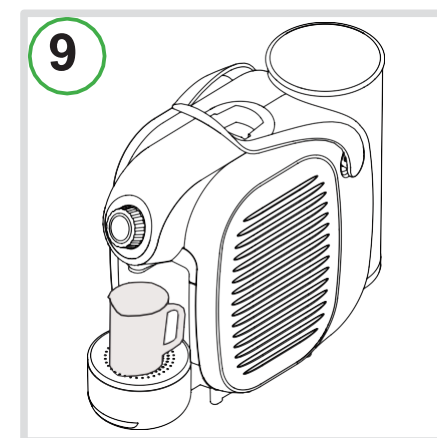
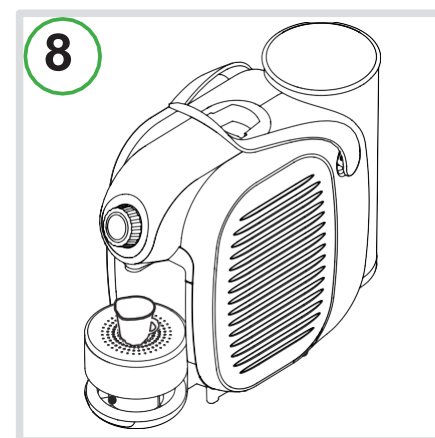
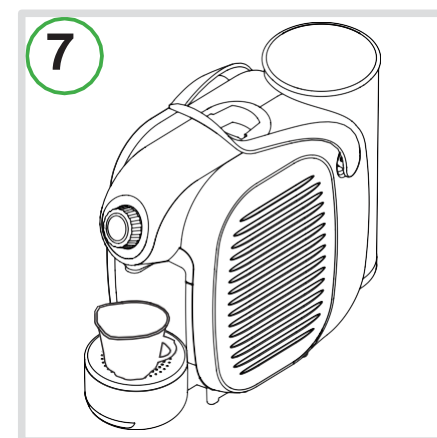
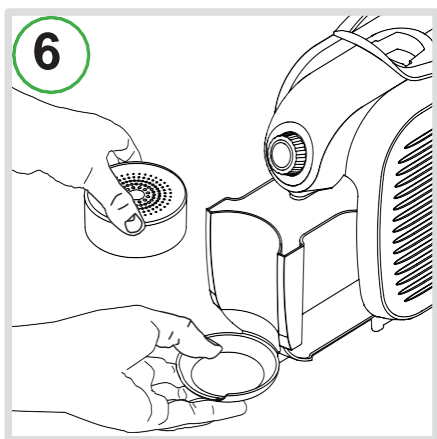
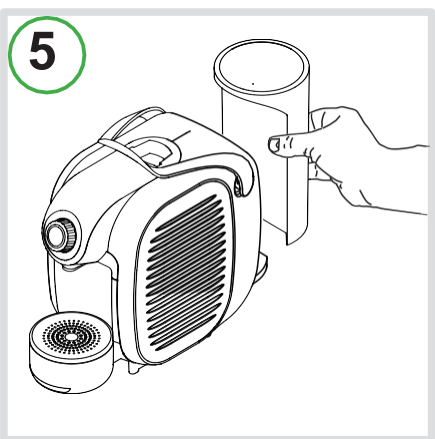
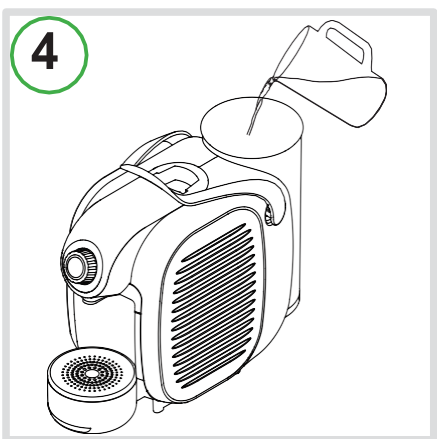
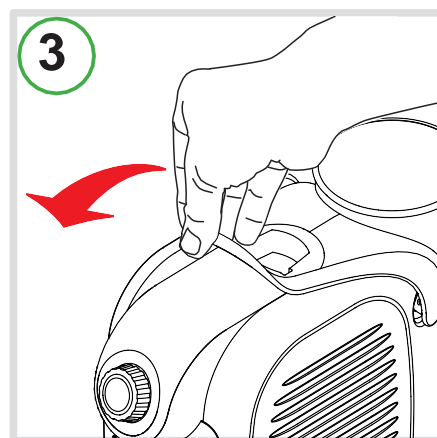
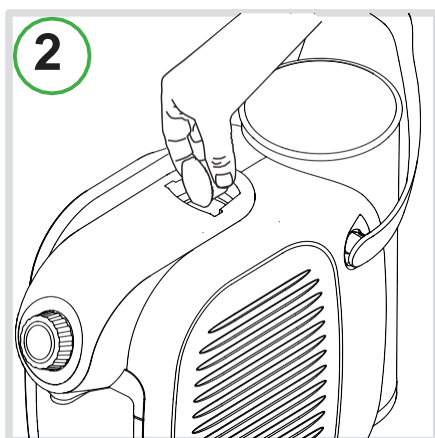
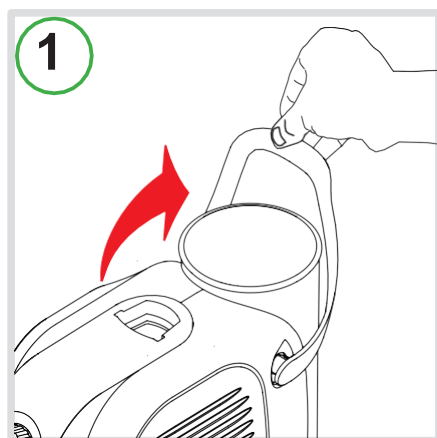

INSTRUCTION DIAGRAMS Continued...

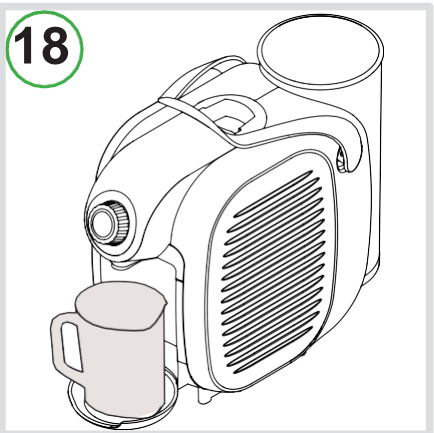
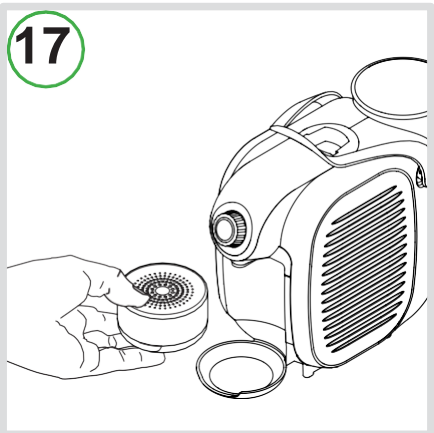
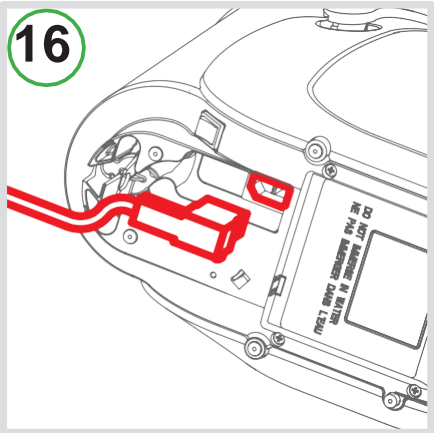
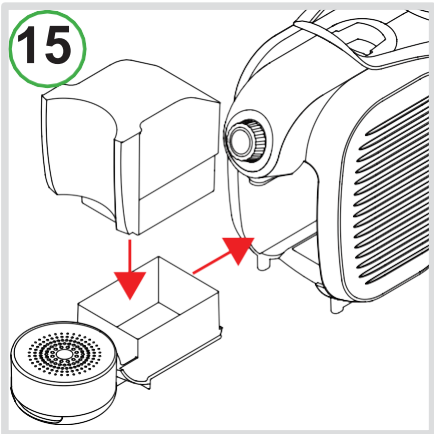
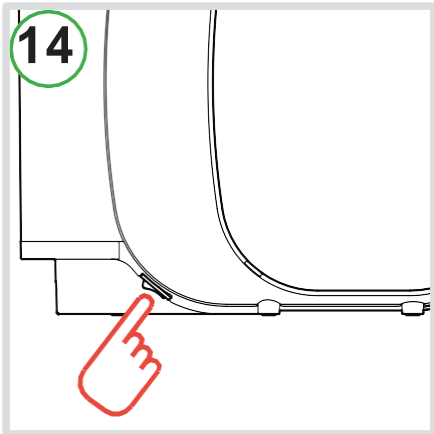
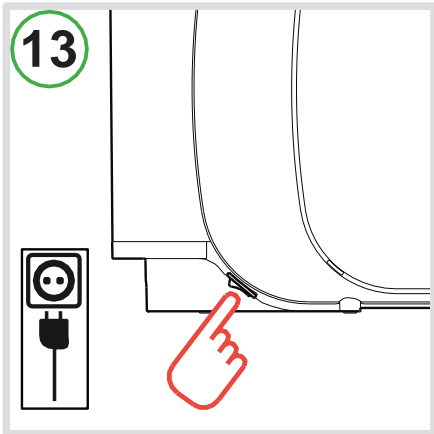

FIRST TIME USE



We recommend following these steps after not having used the machine for a long period of time.

Please ensure you only use Caffitaly System Capsules which can be identified by the Caffitaly logo.



1. Fit the capsule drawer into the drip tray and slot them into the machine (Fig. 15).
2. Plug the power cord supplied into the relevant socket on the bottom of the appliance (Fig. 16).
3. Fill the tank with fresh, still water (Fig. 4).
4. Make sure the lever is closed (Fig. 3).
5. Plug in the appliance and turn it on (Fig. 13).
As well as warning lights A-B-C, warning light D also blinks RED.
6. Place a large container (at least 250 ml) under the dispensing spout (Fig. 9).
Press button E. Wait for the machine to complete the priming cycle and fill with water.

NOTE: if warning light D continues to blink RED after the filling cycle, repeat the previous steps.

Warning lights A-B-C-D will blink simultaneously to indicate that the machine is warming up.

7. When warning light D and the light indicated by the knob (A,B or C) are lit steadily, and the machine beeps twice, perform a rinse cycle by pressing button E.
8. Press the button E again to rinse a second time. Wait for the machine to complete the rinse cycle.
9. At the end of this operation, empty out the water from the used capsule drawer (Fig. 6).

CORRECT USE OF THE DIAL

- To dispense a 'Single Espresso (A) Double Espresso (B), before pressing button E, turn the knob so that it is aligned with warning light A or B (1st and 2nd from the left respectively, lit in WHITE).
- The selected warning light comes on and the machine beeps. This procedure also applies when using orzo, ginseng and cocoa capsules or dispensing milk.
- In 'Tea or Hot Water' mode, before pressing button E, turn the knob so that it is aligned with warning light C (3rd from the left, lit in BLUE).
- The blue warning light comes on and the machine beeps. This setting also applies when using tea, chamomile or infusion capsules.

Do not select warning light C when dispensing espresso or any other coffee with an intense flavour. In this function the machine is set for low pressure and this reduces the "crema", diminishes the flavour of the coffee, and could cause a break in the flow.

CORRECT USE OF THE DIAL - Continued...



NOTE: Traces of the beverage just dispensed may remain in the circuit of the machine. To retain maximum beverage flavour, when dispensing milk, hot chocolate or instant drinks, rinse it briefly. Rinsing is carried out by pressing button E without inserting a capsule.

We would advise you to carry out this procedure at least once a week in any case.

TURNING ON THE APPLIANCE

1. Fill the tank with fresh, still water (Fig. 4).
2. Switch on the appliance by pressing the power on/off switch (Fig. 14).
3. Warning lights A-B-C-D will blink simultaneously to indicate that the machine is warming up.

When warning light D and the light indicated by the knob (A,B or C) are lit steadily, and the machine beeps twice, the machine is ready to use.

DISPENSING COFFEE USING FACTORY SETTINGS

1. Raise the lever to open the capsule compartment (Fig. 1).
2. Insert the capsule, pressing it gently into place (Fig. 2).
3. Close the lever fully (Fig. 3).
4. Place a cup or espresso cup under the coffee dispensing spout (Fig. 7 or 8).
5. Turn the knob so it is aligned with warning light A or B, depending on the desired coffee beverage.

The selected warning light (A or B) comes on and the machine beeps.

6. Press and release button E. The machine beeps.
The selected warning light (A or B) flashes, while warning light D remains lit steadily. Dispensing stops when the programmed amount is reached.
7. Raise the lever to eject the used capsule into the drawer (Fig. 1).
8. Close the lever (Fig. 3).

NOTE: the quantities of coffee dispensed can be programmed according to personal taste and the size of the cups or espresso cups used.

To program the quantities, please refer to chapter 'Programming the quantity of coffee in a cup'.

ADJUSTING THE CUP/ MUG HEIGHT

The machine can be adjusted for the use of large cups or espresso cups.

- The machine is initially set for the use of large cups (Fig. 7).
- For the best possible results when using espresso cups, raise the drip tray, expand the bottom part and fix it in place by turning it clockwise (Fig. 10).
- Reposition the drip tray and start using the espresso cups (Fig. 8).

PROGRAMMING THE QUANTITY OF BEVERAGE IN A CUP

1. Raise the lever to open the capsule compartment (Fig. 1).
2. Insert the capsule, pressing it gently into place (Fig. 2).
3. Close the lever fully (Fig. 3).
4. Place a cup or espresso cup under the dispensing spout (Fig. 7 or 8).
5. Turn the knob so it is aligned with warning light A or B, depending on the desired coffee beverage.
The selected warning light (A or B) comes on and the machine beeps.
6. Press and hold button E.
The selected warning light (A or B) flashes, while warning light D remains lit steadily.
7. On reaching the desired amount of coffee, release the button; the machine will beep three times. Now the button is programmed. The quantity of coffee dispensed can be programmed from a minimum of 20 up to a maximum of 250 ml.
8. Raise the lever to eject the used capsule into the drawer (Fig. 1).
9. Close the lever (Fig. 3).

GENERAL OPERATING INDICATIONS

DESCALING SIGNAL:

- When warning light D blink YELLOW every 5 seconds, a descaling cycle should be carried out (see chapter on 'Descaling').

HEATING:

- Warning lights A-B-C-D blink simultaneously.

WHEN THE WATER RUNS OUT DURING OPERATION:

- The water tank is empty when indicator light D blinks RED and the appliance emits 3 beeps followed by a single intermittent beep.
- Fill the water tank with fresh, still water (Fig. 4).
- Press button E. Wait for the machine to complete the priming cycle and fill with water.
- When warning light D and the light selected by the knob (A,B or C) are lit steadily, the machine is ready to use.

IF THE LEVER IS RAISED WHILE DISPENSING:

Raising the lever while dispensing a product (Fig. 1) may cause splashes of hot water. Danger of scalding!

- Warning light D blinks RED. The appliance will immediately stop dispensing.
- Close the lever (Fig. 3).
- Press button E to reset the alarm.
- The appliance is ready for use again.

DAILY MAINTENANCE

1. Remove the drip tray and used capsule drawer (Fig. 6).
2. Lift the used capsule drawer (Fig. 11); empty and rinse it.
3. Remove the grid (Fig. 12). Empty the drip tray and rinse it out with water.
4. Remove the water tank (Fig. 5); empty and rinse it.



NOTE: Traces of the product just dispensed may remain in the circuit of the machine. To retain maximum beverage flavour it is advisable - when dispensing milk, hot chocolate or instant drinks - to perform a short rinse. Rinsing is carried out by pressing button E without inserting a capsule. We would advise you to carry out this procedure at least once a week in any case.



Use a soft cloth and a neutral detergent to clean the surfaces of the appliance. Do not use jets of water to clean the appliance.



The plastic parts of the machine including the Water Tank are **NOT** dishwasher safe.

DESCALING

Descaling signal: when indicator light **D** blinks **YELLOW** every 5 seconds, a descaling cycle should be carried out, as illustrated below. The warning light will only stop blinking yellow once the descaling cycle is complete.



The machine features an advanced program that monitors how much water is used to dispense beverages. This measurement provides the user with indications as to when the machine needs to be descaled.

It is advisable to use the Caffitaly System descaling agent, designed to comply with the technical characteristics of the machine, in full observance of consumer safety. The descaling agent must be disposed of in compliance with manufacturer instructions and/or with current regulations in force in the country where the appliance is used.



CAREFULLY read the directions for use on the packaging of the descaling agent. Avoid contact with eyes, skin and machine surfaces.

Switch the machine off during descaling, and do not lift the lever. A person must be present during the operation.

Do not use vinegar: it could damage your machine!

DESCALING Continued...

1. Switch the machine off by pressing the power on/off switch (Fig. 14).
2. Empty and rinse out the used capsule drawer and drip tray (Fig. 6).
3. Remove and empty the water tank (Fig. 5).
4. Mix the contents of a bottle of Caffitaly System descaling agent with approximately 750 cc. of water (a total of 1 litre) and pour into the tank.
5. Make sure that the lever is lowered (Fig. 3) and that there is no capsule inside the capsule compartment.
6. Remove the drip-tray (Fig. 17).
7. Place a container (at least 500 ml) under the dispenser (Fig. 18).
8. Turn the knob all the way to the left (anticlockwise).
9. Press button E and at the same time switch on the machine by pressing the power on/off switch.
10. The machine beeps twice and warning light D comes on steadily in WHITE.
11. Press button E to start the descaling cycle.

The machine dispenses the descaling solution at intervals (5 doses with a 4-minute pause between each one, for a total duration of about 25 minutes). During this phase, when button E and the knob must not be touched, warning light D blinks in YELLOW and RED alternately.

If the container fills up, empty it out.

12. When the first phase is complete, the machine beeps and warning light D remains steadily lit in WHITE. The water tank is empty.
13. Carefully rinse out the water tank and refill it with fresh water (Fig. 4).
14. Empty and rinse the used capsule drawer, the drip tray and the container used and put them back in place.
15. Press button E to start the rinse cycle.
16. Rinse water (about 500 ml) will be run through the machine. During this phase warning light D blinks YELLOW and RED alternately.
17. When the rinse cycle is complete, the machine beeps and warning lights A-B-C-D blink simultaneously; the machine is warming up.
18. When warning lights A and D are lit steadily and the machine beeps twice, the appliance is ready to use.
19. Carefully empty and rinse out the water tank and refill it with fresh, still water (Fig. 4).
20. Empty and rinse out the used capsule drawer and drip tray (Fig. 6).

ENERGY SAVING

The machine will automatically reduce consumption after 1 hour of inactivity.

Warning lights A-B-C-D blink slowly and sequentially. To restore normal operating conditions, press button E or raise the lever. The appliance will start warming up.

When warning light D and the light selected using the knob (A,B or C) are lit steadily, the machine is ready for use.

INSTRUCTIONS FOR USE AND DISPOSAL



The appliance has been manufactured using high quality materials that can be reused or recycled. Dispose of the appliance in a suitable waste collection centre.

All materials and objects in contact with food products comply with the requirements of European Regulation 1935/2004

TROUBLESHOOTING

PROBLEM

POSSIBLE CAUSE

SOLUTION

No coffee comes out. Indicator light **D** blinks **RED**.

The water tank is empty.

Fill the tank with fresh water. Press button **E** to refill the circuit. When the warning lights remain steadily lit, the appliance is ready for use.

The coffee is not hot enough.

- Cold cups / espresso cups.
- Scale build-up in machine.

- Preheat cup.
- Descale.

The lever cannot be lowered.

- The used capsule drawer is full.
- Capsule stuck inside the machine.

- Empty out the used capsule drawer.
- Remove the used capsule.

Warning light **D** is lit steadily in **RED**.

Heating problems.

Turn off the machine, then turn it back on. If the problem persists, take the machine to an Authorised Service Centre.

When button **E** is pressed to dispense coffee, the machine seems to work but then stops without dispensing any coffee, or only dispenses a tiny amount.

Incorrect quantity programming.











Reprogram the quantity associated with that button. See ch. "Programming the quantity of coffee in a cup".

Coffee is dispensed very slowly, and is of poor quality.

Warning light **C** was selected with an espresso capsule.

Select warning lights **A** or **B**.

TECHNICAL DATA

	See the data plate on the base of the machine.
	Max. 15 bar
	< 70 dBA
	About 4 kg
	1 litre
	Ambient temperature: 10°C - 40°C
  162 mm  283 mm  370 mm	



caffitalysystem.com.au