

MODEL S06HS QUICK START GUIDE: FIRST TIME USE



TIP: The quantities of beverage dispensed can be programmed. Please refer to chapter "Programming the quantity of coffee in a cup" in your Manual.

Diagram 1

- Indicator Light**
(Orange=Descale | Red=Check System)
- Single Espresso Button**
30ml (Lit White)
- Double Espresso Button**
60ml (Lit White)
- Tea Button** - 120ml (Lit Blue)
WARNING: Only use tea button for tea.



**ONLY USE WITH
Caffitaly System
Capsules**

For instructions on frothing or steaming milk using the Steam Wand, please refer to the Product Manual.

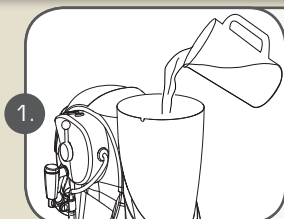

1. Fill the tank with fresh, still water (either by filling through the water tank cover or removing the water tank).

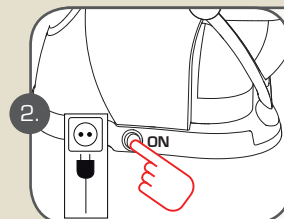

2. Plug in appliance. Switch machine on using the On/Off Switch.

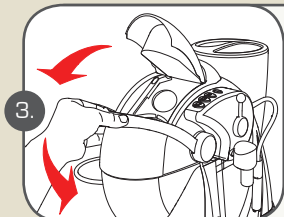

3. Make sure the lever is closed.

*Ensure there is no capsule in machine.

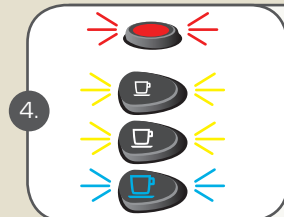

4. Along with the button lights, the indicator light will also blink RED.

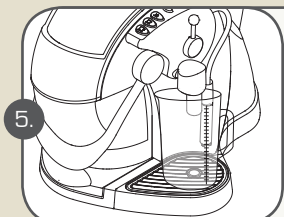

5. Place a large empty container (at least 250 ml) under the coffee dispensing spout.

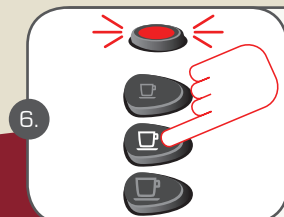

6. Press the Double Espresso button. The machine will draw water through the system (Approx. 30 sec.). When done, the indicator light will switch off.



7. **NOTE:** If the buttons and the indicator light continue to blink and no water has been extracted, repeat Step 6.

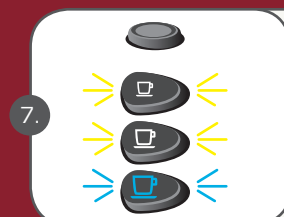

8. Once successfully primed, all the button lights will continue to blink while the machine is warming up (Approx. 1 min.).

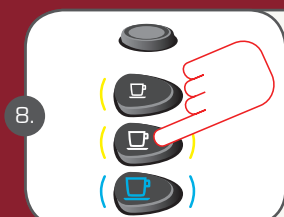

9. When all the button lights remain steadily lit, rinse by pressing the Double Espresso button. Press again to repeat cycle.

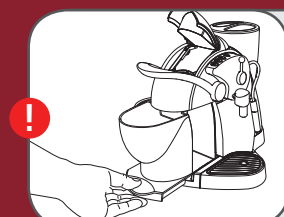

WARNING: During the priming and rinsing stage, **HOT WATER** will be collected in the used capsule drawer. **Danger of scalding.**

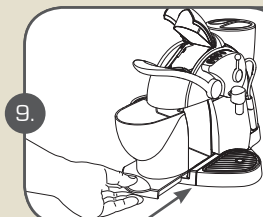

11. At the end of this operation, raise the lever and carefully remove the used capsule drawer. Empty the water, rinse and replace.



12. When all the button lights are lit steadily, the machine is ready to use.

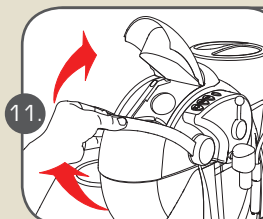

13. Raise the lever to open the capsule compartment.

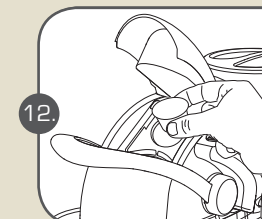

14. Insert the capsule, pressing it gently into place.

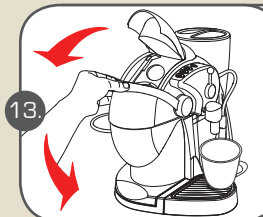

15. Close the lever fully and place a cup or mug under the coffee dispensing spout.

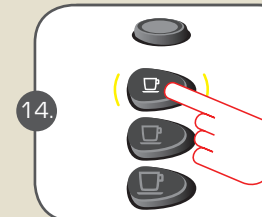

16. Press and release the button corresponding to the type of beverage you want as per **DIAGRAM 1** above.

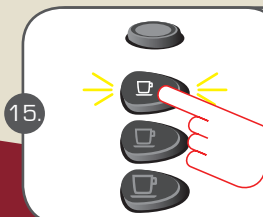

17. The selected beverage button will blink and machine will stop dispensing on reaching the programmed quantity.

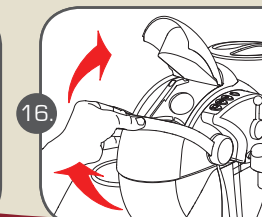

18. Gently raise the lever to eject the used capsule into the drawer and then close the lever.

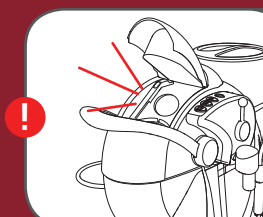

WARNING: There may be some residual **HOT WATER** within the capsule area. Stand to the side of the machine when opening the lever.

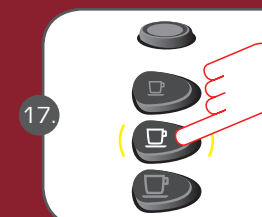

20. Cycle water through the system by pressing the Double Espresso button after dispensing a coffee or other hot beverage.

COMPATIBLE WITH CAPSULE RANGES FROM



For more information visit our website: www.caffitalysystem.com.au

Caffé MENU

See Manual or Website for More Information - caffitalysystem.com.au







Caffitaly
system

MODEL S06HS

* Accessories sold separately.

S06HS CAPSULE MACHINE - BUTTONS

-  Single Espresso Button - 30ml (Lit White)
-  Double Espresso Button - 60ml (Lit White)
-  Tea Button* - 120ml (Lit Blue) ***WARNING TEA ONLY!**

STEAM WAND CONTROLS:  Hot Water (Forward)  Steam/Frothing (Backward) Centre = OFF



ONLY USE WITH
Caffitaly System
Capsules

* For further instructions on frothing or steaming milk using the Steam Wand, please refer to the Manual.



ESPRESSO



- > Select your favourite Caffitaly compatible capsule.
- > Press the **Single Espresso Button** to extract a 30ml shot of coffee into your cup.



LONG BLACK



- > Select your favourite Caffitaly compatible capsule. Press the **Single Espresso Button** to extract a 30ml shot of coffee into your cup.
- > Discard capsule into the capsule drawer by raising and lowering the lever.
- > To top up your cup, place your cup under the Steam Wand and turn the Control lever forwards to **Hot Water** until the desired amount of hot water is dispensed, then move the control lever back to the central position to finish.*



FLAT WHITE



- > Select your favourite Caffitaly compatible capsule. Press the **Single Espresso Button** to extract a 30ml shot of coffee into your cup.
- > **Steam** milk in a jug using the Steam Wand until it reaches your desired temperature.* Once finished, add to your coffee and enjoy.



LATTE



- > Select your favourite Caffitaly compatible capsule. Press the **Single Espresso Button** to extract a 30ml shot of coffee into your cup.
- > **Steam** milk in a jug using the Steam Wand until it reaches your desired temperature.* Once finished, add to your coffee and enjoy.



CAPPUCCINO



- > Select your favourite Caffitaly compatible capsule. Press the **Single Espresso Button** to extract a 30ml shot of coffee into your cup.
- > **Froth** milk in a jug using the Steam Wand until it reaches your desired temperature.* Add to your coffee and enjoy.



MOCHA



- > Select your favourite Caffitaly compatible capsule. Press the **Single Espresso Button** to extract a 30ml shot of coffee into your cup. Insert a Gloria Jean's Coffees™ Classic Hot Chocolate Drink capsule.
- > Press the **Double Espresso Button** to extract a 60ml shot into your cup.
- > **Froth** milk in a jug using the Steam Wand until it reaches your desired temperature.* Add to your coffee and enjoy.



CARAMELATTE



- > Use a Gloria Jean's Coffees™ Caramel Indulgence coffee capsule. Press the **Double Espresso Button** to extract a 60ml shot of caramel infused coffee into your cup.
- > **Steam** milk in a jug using the Steam Wand until it reaches your desired temperature.* Add to your caramel infused coffee and enjoy.



MOCHA CARAMELATTE



- > Use a Gloria Jean's Coffees™ Classic Hot Chocolate drink capsule. Press the **Single Espresso Button** to extract a 30ml shot of hot chocolate into your cup.
- > Insert a Gloria Jean's Coffees™ Caramel Indulgence coffee capsule. Press the **Single Espresso Button** to extract a 30ml shot of coffee into your cup.
- > **Steam** milk in a jug using the Steam Wand until it reaches your desired temperature.* Add your choc/caramel infused coffee, stir and enjoy.



CLASSIC HOT CHOCOLATE



- > Use a Gloria Jean's Coffees™ Classic Hot Chocolate drink capsule. Press the **Double Espresso Button** to extract a 60ml shot of chocolate into your cup.
- > **Froth** milk in a jug using the Steam Wand until it reaches your desired temperature.* Add to your chocolate drink, stir and enjoy.



ICED COFFEE



- > Select your favourite Caffitaly compatible capsule. Press the **Single Espresso Button** to extract a 30ml shot of coffee into your cup.
- > Add ice to glass + coffee, cold milk & ice cream (if desired) & enjoy.



ICED MOCHA



- > Select your favourite Caffitaly compatible capsule. Press the **Single Espresso Button** to extract 30ml of coffee into your cup.
- > Insert a Gloria Jean's Coffees™ Classic Hot Chocolate drink capsule. Press the **Double Espresso Button** to extract a 60ml shot of chocolate into your cup.
- > Add ice to glass + coffee, cold milk & ice cream (if desired) & enjoy.



ICED CHOCOLATE



- > Use a Gloria Jean's Coffees™ chocolate drink capsule. Press the **Double Espresso Button** to extract a 60ml shot of chocolate into your cup.
- > Add ice to glass + coffee, cold milk & ice cream (if desired) & enjoy.

Suggestions are based on 180ml - 200ml cup sizes, for larger cups/mugs or for increased strength & flavour, adjust both the capsule quantity and milk quantity to desired amount within the capability of both capsule and milk systems. All drinks may also require sweetener as desired. Please also read directions on Capsule Retail Box for further instructions as they may differ slightly from these instructions.